

REVISIONS		
NO.	DESCRIPTION	DATE

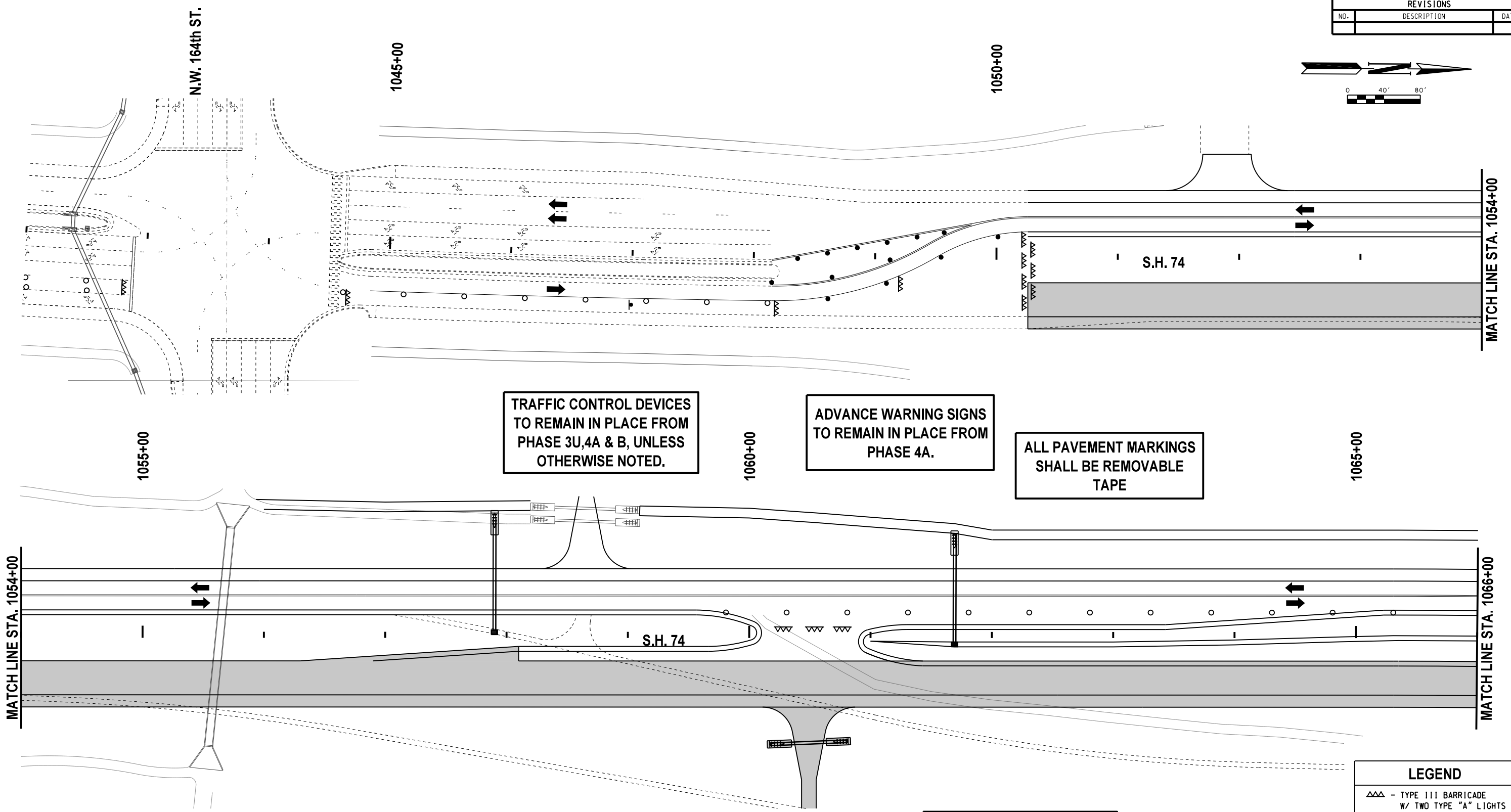
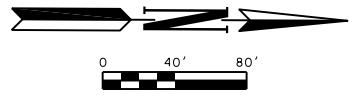

TRAFFIC CONTROL DEVICES TO REMAIN IN PLACE FROM PHASE 3U,4A & B, UNLESS OTHERWISE NOTED.

ADVANCE WARNING SIGNS TO REMAIN IN PLACE FROM PHASE 4A.

ALL PAVEMENT MARKINGS SHALL BE REMOVABLE TAPE

CONTRACTOR SHALL KEEP 11' MINIMUM LANES UNLESS OTHERWISE NOTED.

CONTRACTOR TO PROVIDE ACCESS TO ALL DRIVEWAYS DURING CONSTRUCTION.

LEGEND

- △△ - TYPE III BARRICADE W/ TWO TYPE "A" LIGHTS
- - DRUM
- - CHANNELIZER CONE
- ▬ - PORTABLE CONC. BARRIER WALL
- ▬▬ - CONSTRUCTION ZONE IMPACT ATTENUATOR
- - WORK AREA

Design	RWR	08/10/17
Drawn	GDB	08/10/17



TRAFFIC CONTROL PHASES 4F & G (SHEET 1 OF 3)
S.H. 74 (STA. 1042+00 TO 1066+00)
 State Job No. 14964(08) Sheet No. T101

08/10/17 G:\Projects\T-1662B SH 74 @ NW 178th, NW 192nd & NW 206th\CAD\TC PHASE 4F,G,LSH 74.dgn